

Scholars View | Hetton-le-hole

4 bedroom town house | Type B | 1146 sq.ft. | 106 sq.m. approx

GROUND FLOOR
403 sq.ft. / 37 sq.m. approx

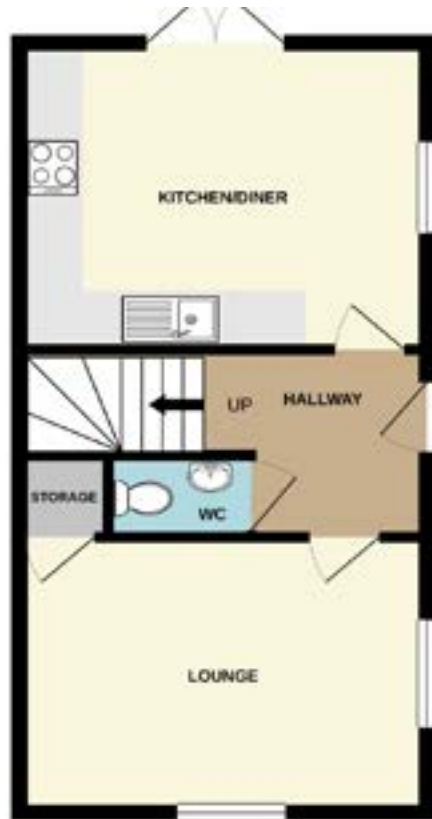

FIRST FLOOR
403 sq.ft. / 37 sq.m. approx

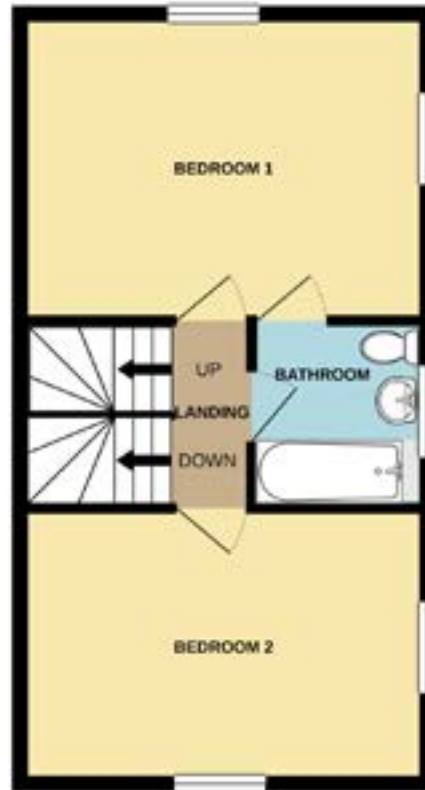

SECOND FLOOR
338 sq.ft. / 31 sq.m. approx



placefirst

If you're interested in a new homes at Scholars View, please call: 0330 058 1905
Alternatively, email us at: scholarsview@placefirst.co.uk or visit www.placefirst.co.uk